

PERHAM MUNI (16D) 2 NW UTC-6(-5DT) N46°36.66' W95°36.37'

1376 B NOTAM FILE PNM

RWY 13-31: H4102X75 (ASPH) MIRL

RWY 13: REIL. PAPI(P4L)—GA 3.0° TCH 45'.

RWY 31: REIL. PAPI(P4L)—GA 3.0° TCH 45'.

SERVICE: FUEL 100LL LGT MIRL Rwy 13-31 preset to low ints, to incr ints and ACTIVATE PAPI Rwy 13 and Rwy 31; REIL Rwy 13 and Rwy 31—CTAF.

AIRPORT REMARKS: Unattended. Fuel avbl 24 hrs with credit card. Ultralights on and invof arpt. Helicopter ops, northwest corner of arpt.

AIRPORT MANAGER: (218) 346-4455

COMMUNICATIONS: CTAF 122.9

MINNEAPOLIS CENTER APP/DEP CON 126.1

GCO 121.725

CLEARANCE DELIVERY PHONE: For CD if una via GCO ctc Minneapolis ARTCC at 651-463-5588.

RADIO AIDS TO NAVIGATION: NOTAM FILE DTL.

DETROIT LAKES (T) (T) VOR/DME 111.2 DTL Chan 49 N46°49.53' W95°53.24' 136° 17.3 NM to fld. 1385/2E. VOR/DME unmonitored.

TWIN CITIES

L-14H

IAP

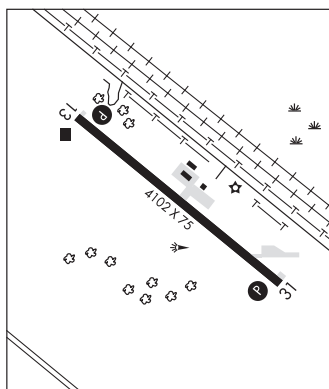

PINE RIVER RGNL (PWC)(KPWC) 1 E UTC-6(-5DT) N46°43.49' W94°22.90'

1296 NOTAM FILE PWC

RWY 16-34: H3000X75 (ASPH) MIRL

RWY 16: REIL. VASI(V2L)—GA 3.0° TCH 22'.

RWY 34: REIL. VASI(V2L)—GA 3.0° TCH 22'.

SERVICE: FUEL 100LL LGT Actvt or incr instst REIL Rwy 16 and 34; VASI Rwy 16 and 34; MIRL Rwy 16-34—CTAF. MIRL Rwy 16-34 preset med instst.

AIRPORT REMARKS: Unattended. Deer and waterfowl on and invof arpt.

Ultralights on and invof arpt. For emerg call 218-821-3521. Fuel avbl H24 self ser via credit card. Aft hrs call 218-821-3521. Cfm snow removal and winter conds call 218-821-3521. Rwy 34 calm wind rwy.

AIRPORT MANAGER: 218-587-2440

WEATHER DATA SOURCES: AWOS-3 118.525 (218) 587-3420.

COMMUNICATIONS: CTAF 122.9

MINNEAPOLIS CENTER APP/DEP CON 118.05

CLEARANCE DELIVERY PHONE: For CD ctc Minneapolis ARTCC at 651-463-5588.

RADIO AIDS TO NAVIGATION: NOTAM FILE PKD.

PARK RAPIDS (L) DME 110.6 PKD Chan 43 N46°53.89' W95°04.26' 110° 30.3 NM to fld. 1472.

TWIN CITIES

L-14H

IAP

