

DAYTON EIGHT DEPARTURE  
(DAY8.DAY) 16MAY24

JAMES M COX DAYTON INTL (DAY)  
DAYTON, OHIO

ATIS  
125.8  
CLNC DEL  
121.75  
GND CON  
121.9  
DAYTON TOWER  
119.9 257.7  
COLUMBUS DEP ON  
118.85 305.2 (091°-180°)  
134.45 323.15 (181°-090°)

RADAR required.

TOP ALTITUDE:  
5000

TAKEOFF MINIMUMS:  
Rwy 6L/R, 24L/R, 36: Standard.  
Rwy 18: 300-1 or standard with a minimum  
climb of 305' per NM to 1300.

DRYER  
113.6 DJB  
Chan 83

PIONS

KLOEE

REELS

N

FORT WAYNE  
117.8 FWA  
Chan 125

ROSEWOOD  
117.5 ROD  
Chan 122

MUNCIE  
114.4 MIE  
Chan 91

DAYTON  
114.5 DQN  
Chan 92

APPLETON  
116.7 APE  
Chan 114

BRICKYARD  
116.3 VHP  
Chan 110

YELLOW BUD  
112.5 XUB

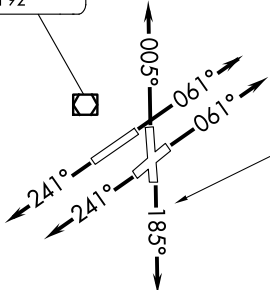
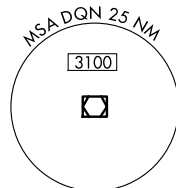

(CONTINUED ON FOLLOWING PAGE)

NOTE: Chart not to scale.

(DAY8.DAY) 24137  
DAYTON EIGHT DEPARTURE

A1-107 (FAA)

JAMES M COX DAYTON INTL (DAY)  
DAYTON, OHIO

# DAYTON EIGHT DEPARTURE



## DEPARTURE ROUTE DESCRIPTION

TAKEOFF RUNWAYS 6L/R: Climb on heading 061°, thence....

TAKEOFF RUNWAY 18: Climb on heading 185°, thence....

TAKEOFF RUNWAYS 24L/R: Climb on heading 241°, thence....

TAKEOFF RUNWAY 36: Climb on heading 005°, thence....

....or assigned RADAR vectors to join assigned route/fix. All aircraft maintain 5000 or filed altitude if lower. Expect clearance to requested altitude/flight level 10 minutes after departure. Appropriate departure control frequency will be assigned by ATC. Aircraft filed over APE VORTAC, expect vectors to intercept APE R-260.

EC-2, 20 MAR 2025 to 17 APR 2025

EC-2, 20 MAR 2025 to 17 APR 2025

# DAYTON EIGHT DEPARTURE