

# AIRPORT DIAGRAM

CITY OF COLORADO SPRINGS MUNI (COS)  
AL-87 (FAA) COLORADO SPRINGS, COLORADO

SW-1, 09 JUL 2026 to 06 AUG 2026

SW-1, 09 JUL 2026 to 06 AUG 2026

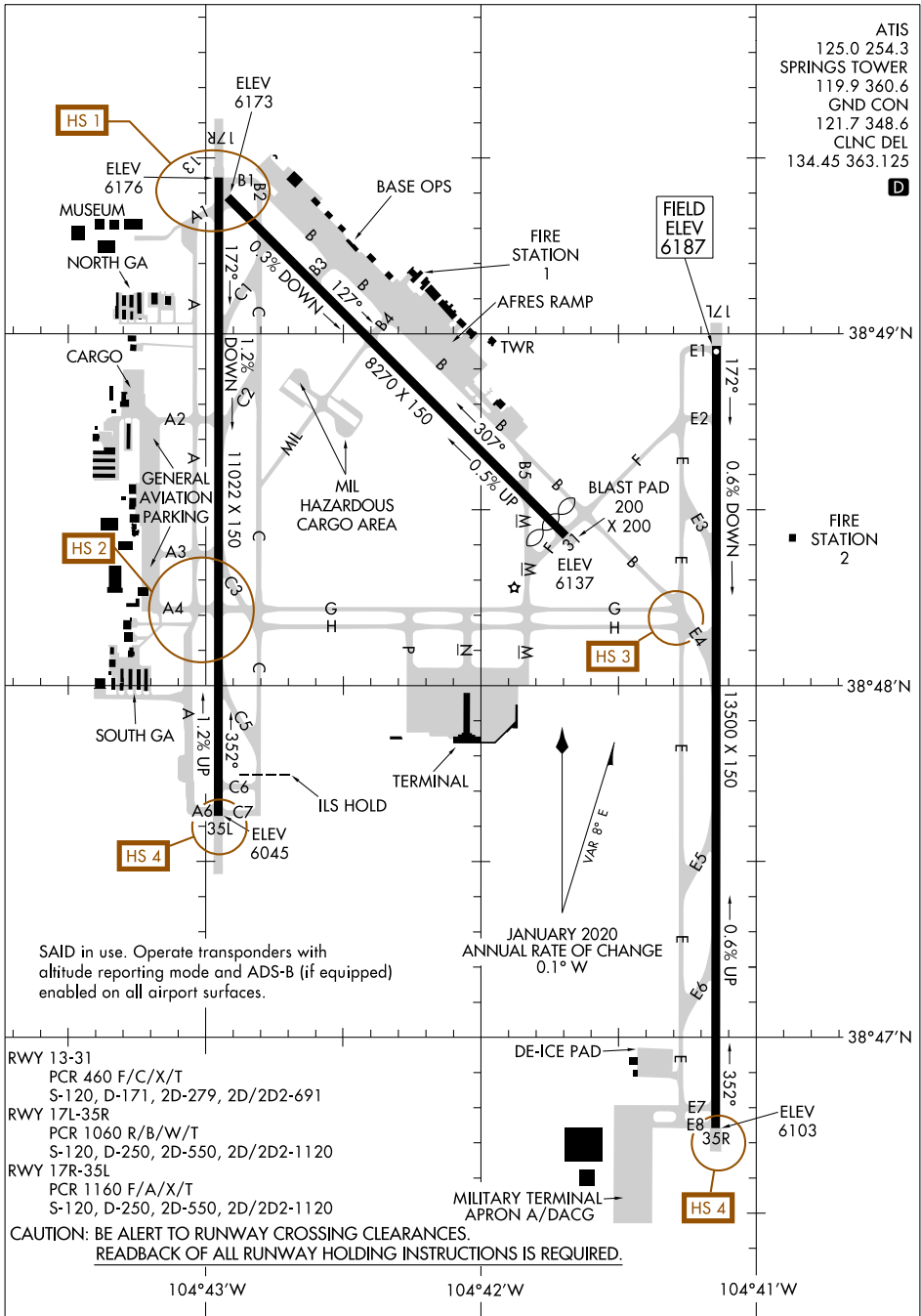

# AIRPORT DIAGRAM

COLORADO SPRINGS, COLORADO  
CITY OF COLORADO SPRINGS MUNI (COS)

SAID in use. Operate transponders with altitude reporting mode and ADS-B (if equipped) enabled on all airport surfaces.

CAUTION: BE ALERT TO RUNWAY CROSSING CLEARANCES.  
READBACK OF ALL RUNWAY HOLDING INSTRUCTIONS IS REQUIRED.