

JACKSON MUNI (MJQ)(KMJQ) 2 N UTC-6(-5DT) N43°39.05' W94°59.19'

OMAHA

1446 B NOTAM FILE MJQ

L-121

RWY 14-32: H4145X75 (ASPH) S-8, D-10 MIRL 0.3% up SE

RWY 14: REIL. PAPI(P4L)—GA 3.0° TCH 26'. Thld dsplcd 541'.

RWY 32: REIL. PAPI(P4L)—GA 3.0° TCH 26'. Thld dsplcd 541'.

RWY 04-22: 2282X300 (TURF)

RWY 22: Crops.

IAP

RUNWAY DECLARED DISTANCE INFORMATION

RWY 14: TORA-3600 TODA-3600 ASDA-4145 LDA-3600

RWY 32: TORA-3600 TODA-3600 ASDA-4145 LDA-3600

SERVICE: S4 FUEL 100LL, JET A LGT ACTVT or incr instst REIL Rwy 14 and 32; PAPI Rwy 14 and 32; MIRL Rwy 14-32—CTAF. MIRL Rwy 14-32 preset low instst. VSGI: Rwy 14 PAPI unusbl byd 6 deg left of crs.

AIRPORT REMARKS: Attended Mon-Fri 1400-2300Z†. Rwy 04-22 CLOSED winter months. 100LL avbl H24 with credit card. For svc after hrs call 507-447-2675. Rwy 04-22 marked with yellow cones. Access code to arrival/departure building is CTAF frequency.

AIRPORT MANAGER: 507-847-3599

WEATHER DATA SOURCES: AWOS-3 118.1 (507) 847-5810.

COMMUNICATIONS: CTAF/UNICOM 122.8

MINNEAPOLIS CENTER APP/DEP CON 127.75

GCO 121.725 (MINNEAPOLIS CENTER and FLIGHT SERVICES)

CLEARANCE DELIVERY PHONE: For CD if una via GCO ctc Minneapolis ARTCC at 651-463-5588.

RADIO AIDS TO NAVIGATION: NOTAM FILE FRM.

FAIRMONT (DH) DME 114.25 FNX Chan 89(Y) N43°38.27' W94°24.79' 272° 25.0 NM to fld. 1214.

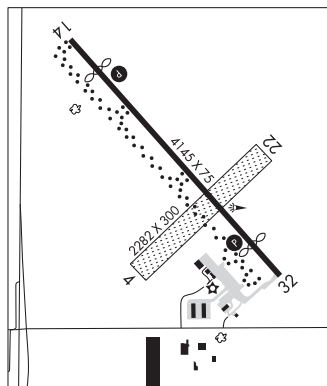

JOLLY FISHERMAN SPB (See WAUBUN on page 218)

KARLSTAD MUNI (23D) 1 W UTC-6(-5DT) N48°34.66' W96°32.48'

TWIN CITIES

1025 NOTAM FILE PNM

RWY 17-35: 2606X159 (TURF) LIRL(NSTD)

RWY 35: Road.

SERVICE: LGT Rwy 17-35 Nstd LIRL due to 400' btn lgts, LIRLs heaving out of the ground.

AIRPORT REMARKS: Unattended. Rwy 17-35 marked with yellow cones. Ruts in ramp.

AIRPORT MANAGER: 218-436-2178

COMMUNICATIONS: CTAF 122.9

CLEARANCE DELIVERY PHONE: For CD ctc Minneapolis ARTCC at 651-463-5588.

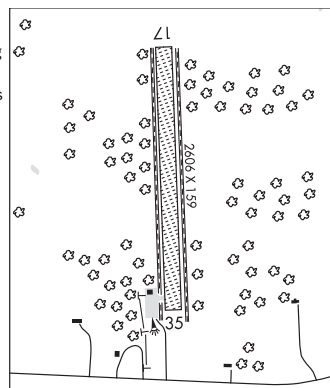

LAC QUI PARLE CO (See MADISON on page 183)

LAKE BEMIDJI N47°30.46' W94°55.40' NOTAM FILE BJI.

TWIN CITIES

(T) (T) VORW/DME 110.0 IDJ Chan 37 at Bemidji Rgnl. 1384/1E.

LAKE ELMO (See ST PAUL on page 207)

LAKESIDE N46°50.63' W92°11.16' NOTAM FILE DLH.

GREEN BAY

(H) TACAN 135.4 LKI Chan 11 at Duluth Intl. 1424/OW.

H-21, L-10G

Opr 1300-0400Z† Tue-Fri 1300-2200Z† Mon and Sat. No NOTAM MP: Thu 1400-1600Z†

TAC AZM unusable:

045°-060° byd 38 NM blo 3,500'

145°-175°

335°-350°